



SBZ 616/01

Cutting and machining
centers



Automatic cutting centre for PVC profiles. Loading magazine for up to nine profiles. Lifting function for cycling the empty compartments. In- and outfeed with motorised, continuously adjustable gripper. Rubberized gripper jaws prevent profile damage. Pneumatic blade feed. Outfeed for parts via discharge table. Options: feed with servo drive; label printer; outfeed for parts via a belt conveyor protects profiles and offers different capacities; gasket downholder for precision gasket cutting; high fences for precision cuts on high profiles.



LAYOUT

Left version (left to right)

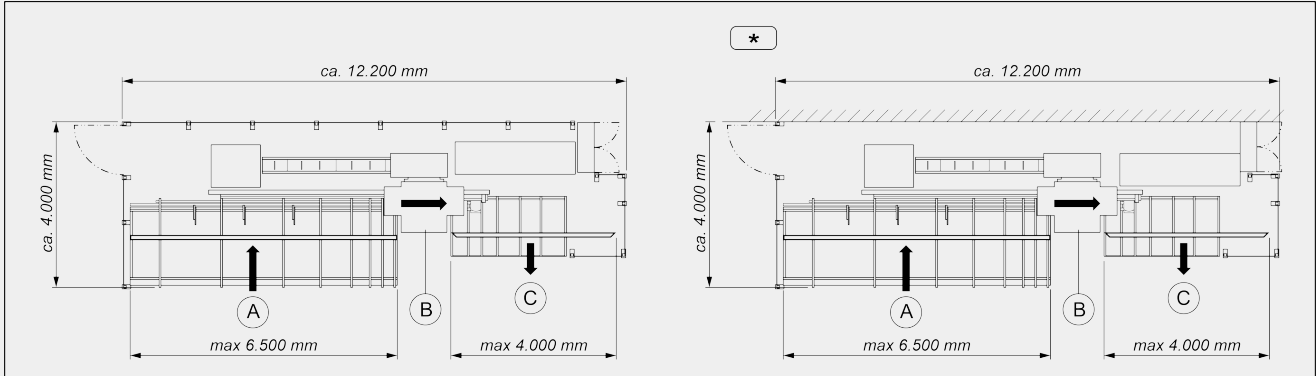

Right version (right to left)

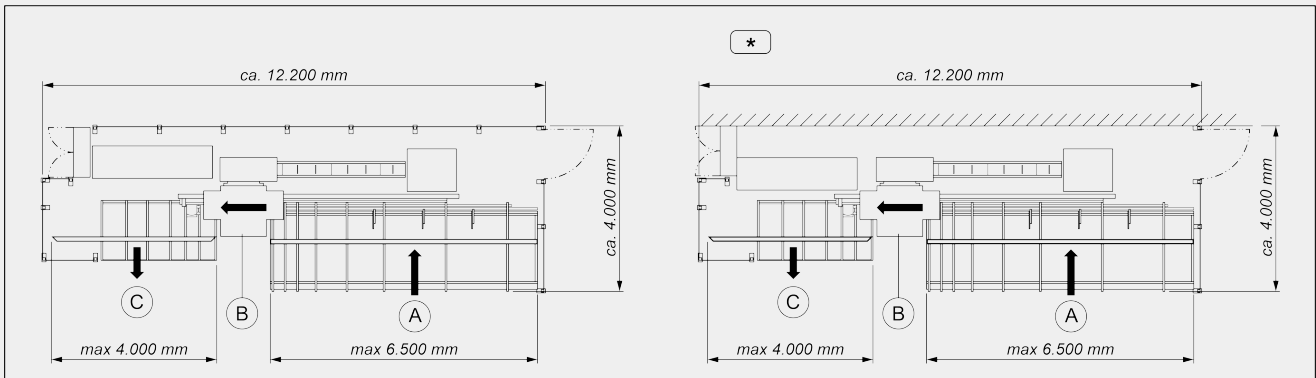

- A - Loading magazine
- B - Machining unit
- C - Unloading magazine
- * - Standard version

The overall dimensions may vary depending on the product configuration.

AXIS TRAVEL

X AXIS (bar positioning) (mm)	3.430
Y1 AXIS (gripper transversal positioning) (mm)	130
Z1 AXIS (gripper vertical positioning) (mm)	130

MACHINABLE CUTTING ANGLES

Cutting angle	22°30' ÷ 157°30'
---------------	------------------

Voilàp S.p.A.
 Via Archimede, 10
 41019 - Limidi di Soliera (MO)
 ITALY

Tel 059 895411
 Fax: 059 859404
 P.IVA e C.F. 02057270361
 info@somecopvc.com
 www.somecopvc.com

The right to make technical alterations is reserved.



LOADING UNIT: PROFILE POSITIONING

Workpiece reference stop near the working unit	<input checked="" type="radio"/>
Maximum loadable length (mm)	6.500
Loading feeder with 2 controlled axes for workpieces of up to 4.000 mm with gripper	<input checked="" type="radio"/>
Electronically controlled 0 - 180° collet rotation (C1 axis)	<input checked="" type="radio"/>
Minimum machinable profile section W x H (mm)	30 x 30
Maximum profile height W x H (mm)	150 x 150

WORKPIECE LOCKING

Automatic fixed clamping system before machining area	<input checked="" type="radio"/>
Automatic fixed clamping system after machining area	<input checked="" type="radio"/>
Clamping system standard, high 20 mm	<input checked="" type="radio"/>
Clamping system for profile adapted to profile system	<input type="radio"/>

FUNCTIONS

Label printer	<input type="radio"/>
---------------	-----------------------

CUTTING MOTORS (MANUAL CHANGE)

Maximum power rating in S6 (kW)	4
Maximum speed (r.p.m.)	2.850
Air cooling	<input checked="" type="radio"/>
Blade diameter (mm)	550
Number of motors	1
Fixed cutting angle	22°30' ÷ 157°30'

CUTTING DIAGRAM

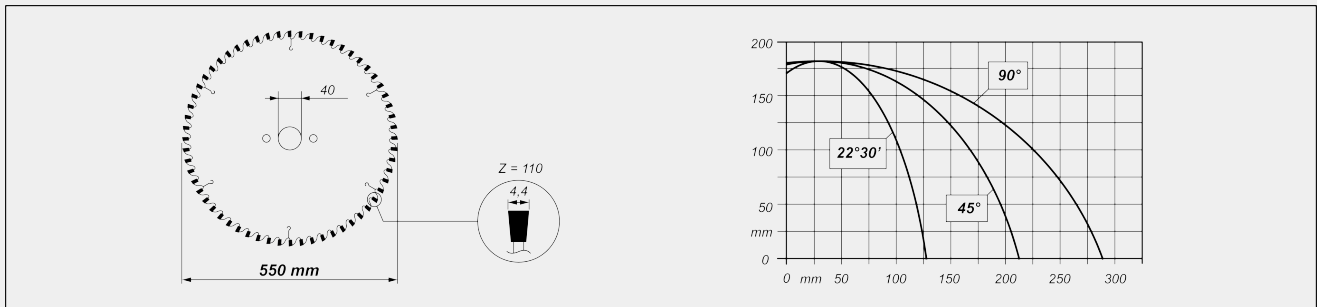



SUPPORT BASE

Monolithic in electrowelded and standardised steel

UNLOADING UNIT

Unloading table with a pneumatic pusher for workpieces of up to 4000 mm

Belt magazine unloading depth (mm)

1.900

ELECTRIC CABINET COOLING

Electrical cabinet with air conditioner for operating temperature < 45 °C

Electrical panel and CN conditioner for operating temperatures < 50°C

Included ● Available ○